

MITER SAW STAND  
SCHEMATIC

MODEL NO. UU 240F

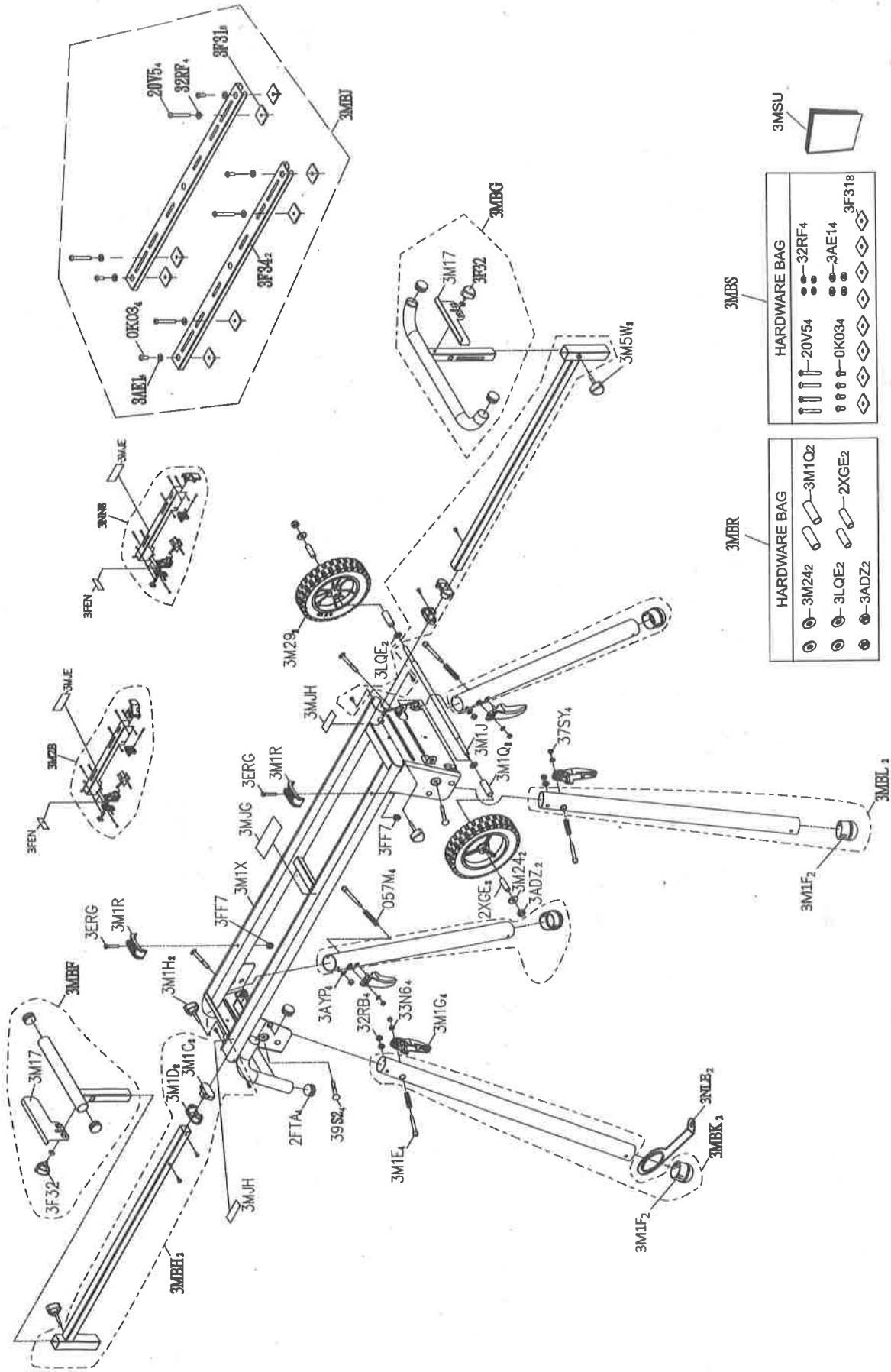

3MSU	
3MBS	HARDWARE BAG
	-20V54     -32RF4 0-K034     -3AE14 
3MBR	HARDWARE BAG
	-3M1Q2 -2XGE2 -3ADZ2

## PARTS LIST

MITER SAW STAND  
PARTS LIST

MODEL NO. UU 240F

Always order by I.D. NO. number

HKU NO.	I.D. NO.	Description	Size	Q'ty
339787	057M	SPRING		4
370335	0K03	HEX. SOC. TRUSS HD. SCREW	M8*1.25-15	4
339788	20V5	HEX. SOC. TRUSS HD. SCREW	M8*1.25-60	4
339789	2FTA	END CAP		4
339790	2XGE	SLEEVE		2
339791	32RB	LOCK NUT	M8*1.25 T=8	4
339792	32RF	FLAT WASHER	φ8*18-2	4
339793	33N6	FLAT WASHER	φ6*13-1.5	4
339794	37SY	LOCK NUT	M6*1.0 T=6	4
339795	39S2	CAP HD. SQ. NECK BOLT	M8*1.25-65	4
339796	3ADZ	LOCK NUT	M10*1.5 T=10	2
339797	3AE1	FLAT WASHER	φ8*28-2.5	4
339798	3AYP	FLAT WASHER	φ8.1*16-2	4
339800	3ERG	HEX. HD. BOLT	M6*1.0-40	2
339801	3F31	SQUARE NUT		8
339802	3F32	KNOB		2
339803	3F34	RAIL		2
339804	3FF7	CROWN NUT	M6*1.0 T=13	2
339866	3FEN	CAUTION LABEL		2
339805	3LQE	FLAT WASHER	φ10*20-2	2
339806	3M17	FENCE		2
339807	3M1C	PLUG-BUTTON		2
339808	3M1D	PLUG-BUTTON		2
339809	3M1E	LOCATION PIN		4
370546	3M1F	PLUG-BUTTON		4
339810	3M1G	PLUNGER HANDLE		4
339811	3M1H	KNOB		2
339812	3M1J	LINK BAR		1
339813	3M1Q	SLEEVE		2
339814	3M1R	GUIDE CLAMP		2
339815	3M1X	TABLE ASS'Y		1
339816	3M24	FLAT WASHER	φ10*25-2	2
339817	3M29	FLOOR WHEEL ASS'Y		2
339818	3M2B	PARALLEL BRACKET ASS'Y		1
339819	3M5W	KNOB		2
339820	3MBF	EXTENSION ARM SUPPORT ASS'Y		1
339821	3MBG	EXTENSION ARM SUPPORT ASS'Y		1
339822	3MBH	EXTENSION ARM ASS'Y		2
339823	3MBJ	AUXILIARY MOUNTING BRACKET ASS'Y		1
339824	3MBK	STAND LEG ASS'Y		2
339825	3MBL	STAND LEG ASS'Y		2
339826	3MBR	WHEELS HARDWARE BAG		1
339827	3MBS	AUXILIARY MOUNTING BRACKET HARDWARE BAG		1
370029	3MJE	TRADEMARK LABEL		2
370030	3MJG	WARNING LABEL		1
370031	3MJH	WARNING LABEL		2
339828	3MSU	INSTRUCTION MANUAL		1
339829	3NLE	ANCHOR PLATE		2
339830	3NN8	PARALLEL BRACKET ASS'Y		1